



# Splyt

Design by LAPD Consultants





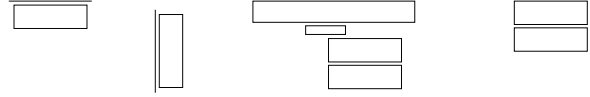

**FR** Résultat de la collaboration de Reggiani Illuminazione avec le cabinet LAPD Consultants, Splyt est un système de projecteurs d'intérieur né d'une demande spécifique visant à offrir des optiques aux performances élevées dans un logement optique de seulement 40 mm.













**ES** Splyt nace de la colaboración de Reggiani Illuminazione con el estudio LAPD Consultants. Es un sistema de proyectores de interior creado para satisfacer la necesidad específica de ofrecer ópticas de elevado rendimiento en un vano óptico de solo 40mm de espesor.



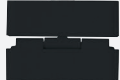

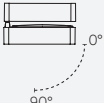

## Overview

Application:	Recessed, Wall, Track, Surface
Light source:	LED Array (MID POWER LED)
Watt:	17 W - 31 W
Kelvin:	3000 K, 4000 K
Lumen:	1420 lm - 3380 lm
CRI:	>80, >90
SDCM:	<3
IP:	20
Control options:	On/Off, Phase-cut, Dimm 1-10V, DALI
Technologies:	Bluetooth

Disponibile pour l'Amérique du Nord: rendez-vous sur [www.reggianiusa.com/](http://www.reggianiusa.com/)  
 Disponible para América del Norte: consulte la página [www.reggianiusa.com](http://www.reggianiusa.com/)



<p><b>Système/ Sistema</b></p>				
<p><b>Versions/ Modelos</b></p>	 <p>Splyt Recessed</p>	 <p>Splyt Recessed (Wall)</p>	 <p>Splyt Track</p>	 <p>Splyt Surface</p>
<p><b>Finitions/ Acabados</b></p>	 <p><b>12</b> Blanc opaque gaufré/ Blanco mate gofrado</p>	 <p><b>28</b> Gris métallisé/ Gris metalizado</p>	 <p><b>31</b> Noir opaque gaufré/ Negro mate gofrado</p>	
<p><b>Faisceaux/ Haces de luz</b></p>	 <p>Très étroit/ Muy estrecho</p>	 <p>Étroit/ Estrecho</p>	 <p>Moyen/ Medio</p>	 <p>Large/ Ancho</p>
<p><b>Orientation/ Orientabilidad</b></p>	 <p>Axe vertical/ Eje vertical</p>	 <p>Axe horizontal/ Eje horizontal</p>		

Dimensions et données techniques/ Dimensiones e información técnica		
	9 LED	16 LED
Splyt Recessed p.611		
	Visible trim 120x120mm Trimless 189x189mm p.614	Visible trim 150x150mm Trimless 219x219mm p.615
		
	Visible trim 189x189mm p.616	Visible trim 219x219mm p.617
Splyt Track p.619		
	p.620	p.621
Splyt Surface p.623		
	p.624	p.625
Encombrement intérieur max/ Dimensiones interiores máximas	 129x129	 159x159
Ouverture du faisceau lumineux/ Amplitud del haz de luz	7°, 12°, 21°, 37°	7°, 12°, 22°, 42°
Source lumineuse/ Fuente luminosa	LED ARRAY 17 W 1420lm - 1855lm L70 B50=50,000h 3000K, 4000K SDCM <3 CRI >80, CRI >90	LED ARRAY 31 W 2520lm - 3380lm L70 B50=50,000h 3000K, 4000K SDCM <3 CRI >80, CRI >90



Accessoires/  
Accesorios

Accessoires pour optique/  
Accesorios de las ópticas

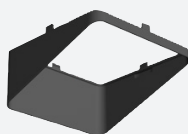

Pare-lumière/  
Visera antideslumbrante

12  
28  
31

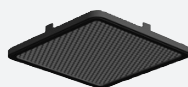

Grille en nid d'abeilles/  
Rejilla alveolar

12  
28  
31

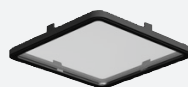

Lentille wall-washer  
Lente Wall washer

12  
28  
31



Lentille pour faisceau elliptique/  
Lente para haz de luz elíptico

12  
28  
31

Accessoires de montage/  
Accesorios de montaje

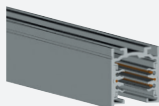

Rail/  
Carril  
p.707

10  
21  
28



Patère rail pour la fixation au  
plafond du projecteur/  
Base para la fijación de techo  
del proyector

10  
21  
28



Adaptateur pour la fixation à encastrer de la  
patère rail /  
Adaptador para la instalación de empotrar de  
la base

10  
21  
28

## Splyt

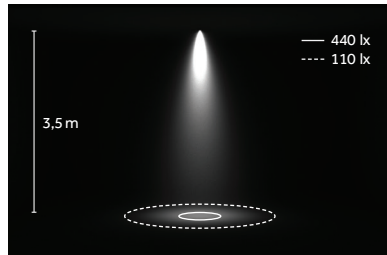
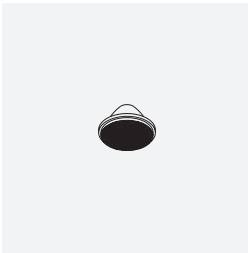

LED: 17 W/21°/3000 K (HQ)

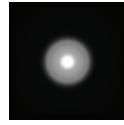

Très étroit/  
Muy estrecho  
7°

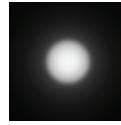

Étroit/  
Estrecho  
12°

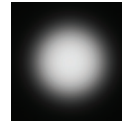

Moyen/  
Medio  
21°/22°



Large/  
Ancho  
37°/42°

## LED ARRAY

### MID POWER LED

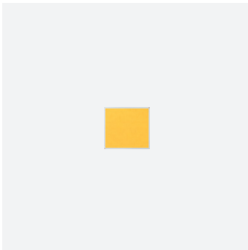

3000 K, 4000 K  
SDCM<3  
CRI>80, CRI > 90

L70 B50=50,000h  
Ta: 25°  
Tc: 85°  
~10.000hr  
Lm Maintenance: 98%  
(Source: LM80 test report)

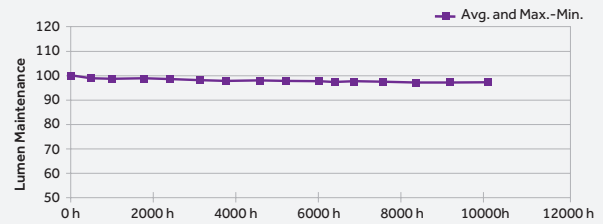
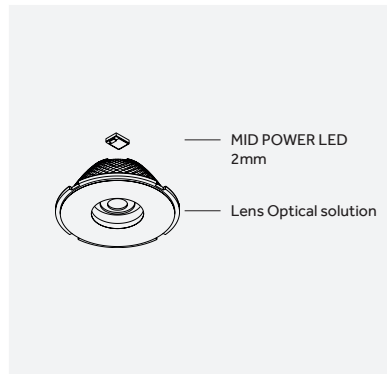

**FR** Excellente densité du flux lumineux allée à une compacité unique pour un contrôle optique précis. Le MID POWER LED se distingue par des performances exceptionnelles dans des dimensions extrêmement compactes : une solution optimale pour des appareils avec faisceaux très étroits (< 15°). Cette source lumineuse peut être intégrée dans des produits dont les dimensions sont très réduites tout en offrant des valeurs de flux lumineux et un rendement (lm/W) très élevés.

**ES** Excelente densidad del flujo luminoso y dimensiones reducidas para un control óptico de precisión. Un LED de media potencia (MID POWER LED) muy compacto, que garantiza un rendimiento excepcional y es la solución ideal para aparatos con haces de luz muy estrechos (< 15°). Esta fuente luminosa puede incorporarse en aparatos de tamaño pequeño, garantizando elevados valores de flujo y de eficacia (lm/W).

FR Splyt offre une grande flexibilité d'utilisation grâce à une rotule mécanique qui permet d'orienter le logement optique de l'appareil sur les deux axes.

ES Splyt es sumamente flexible gracias a una articulación mecánica que permite orientar el vano óptico del aparato en ambos los ejes.

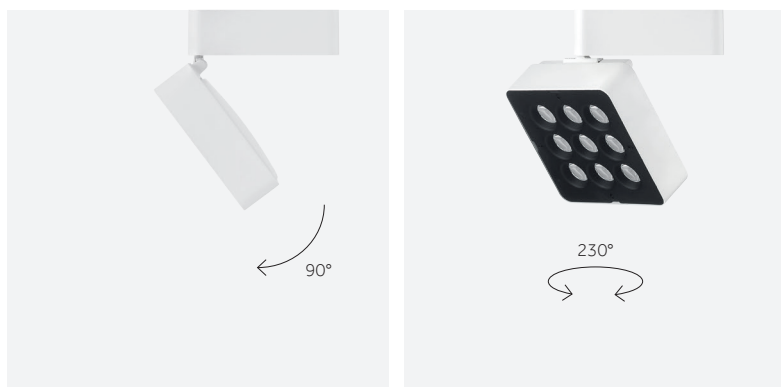

FR Axe horizontal  
ES Eje horizontal

FR Axe vertical  
ES Eje vertical

FR Splyt dispose d'accessoires anti-éblouissement et de lentilles spécifiques destinés à modifier la distribution lumineuse en fonction des nécessités du projet d'éclairage envisagé.

ES Splyt dispone de específicos accesorios antideslumbrantes y lentes para modificar la distribución luminosa según la necesidad de cada diseño luminotécnico.



FR Pare-lumière  
ES Visera antideslumbrante

FR Grille en nid d'abeilles  
ES Rejilla alveolar

FR Lentille pour faisceau elliptique  
ES Lente para haz de luz elíptico

FR Lentille wall-washer  
ES Lente wall-washer

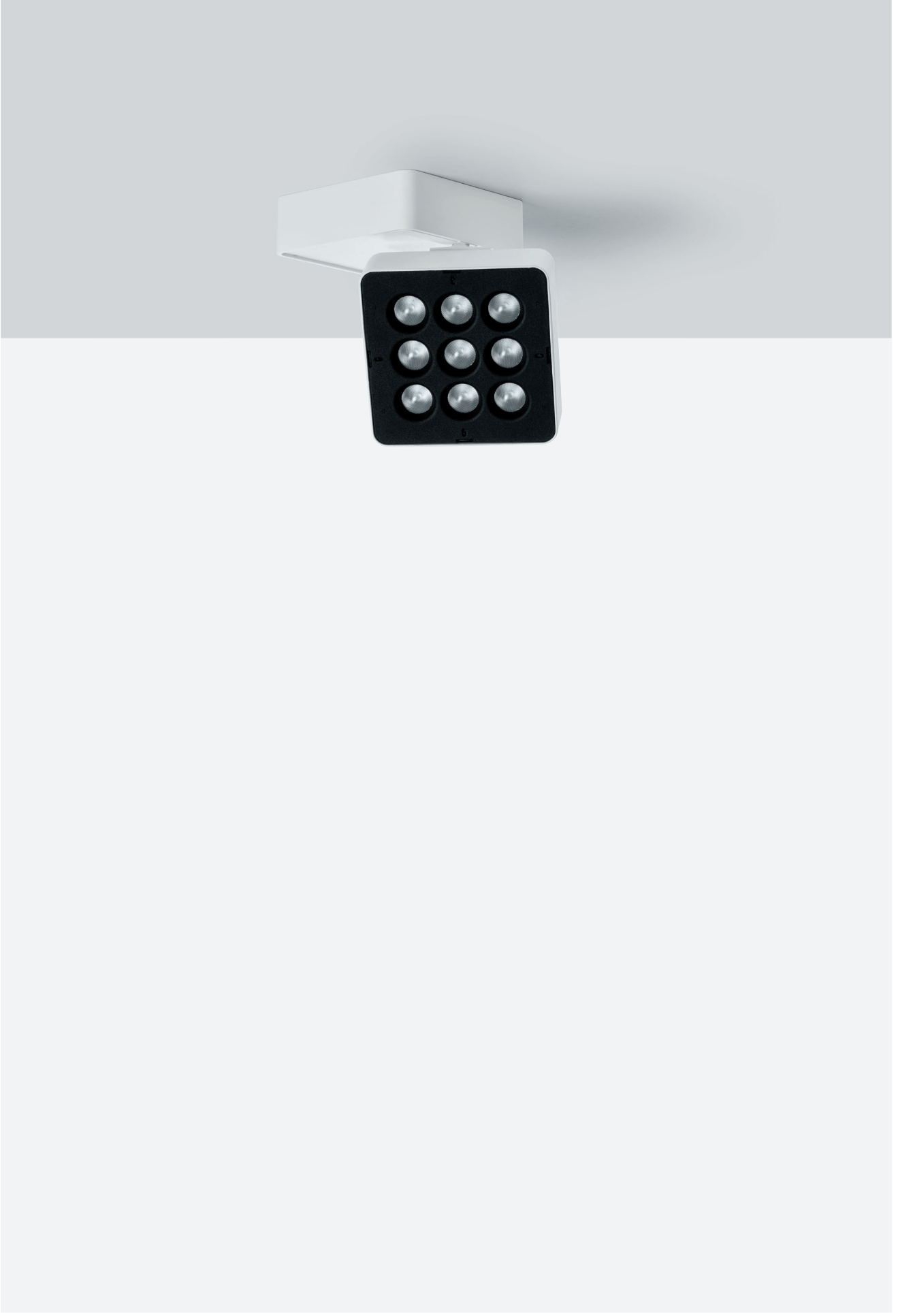

609



—

# Splyt Recessed

# Splyt Recessed

FR Splyt Recessed se prête aussi bien à une installation au plafond qu'à une fixation murale. Cette dernière version dispose d'un boîtier spécifique en plastique pour la fixation murale, muni d'entrées latérales pour faciliter l'opération de câblage. La version avec installation au plafond est également proposée avec collerette visible et invisible.

ES Splyt Recessed se encuentra disponible en dos modelos para la instalación de techo y de pared. Este último dispone de una específica caja de material plástico, para la fijación de pared, con muescas laterales para hacer pasar los cables y facilitar el cableado. El modelo de techo se encuentra disponible en las variantes con aro visible e invisible.



FR Boîtier Splyt Recessed Wall

ES Caja para Splyt Recessed de pared





## 9 LED

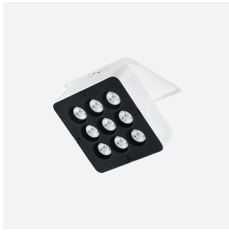

Collerette apparente/  
Con aro visible

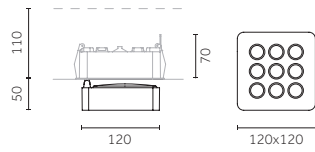

Collerette invisible/  
Con aro invisible

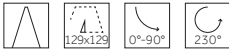
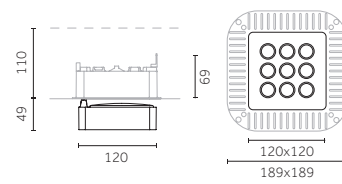

Code example:

0 . Q F3D0 . HQ 12

Accessories: p.614  
Finishes: p.604  
Photometric data:  
www.reggiani.net

Notes:  
Version avec gradateur embarqué  
sur demande/ Modelo con dimmer  
en el aparato bajo pedido

### 17 W LED ARRAY

Lumen delivered up to 1670 lm / Lumen maintenance: L70 B10=50,000h

Driver	Optics	Version	LED	K	CRI	lm	SDCM	Finishes
0 On-Off	Q 7° Vey Narrow	F3D0 Visible trim	HQ	3000	>90	1420	<3	12
T Phase-cut	L 12° Narrow		WW	3000	>80	1660	<3	28
V Dimm 1-10V	M 21° Medium		NN	4000	>80	1855	<3	31
D DALI	N 37° Wide		LED nominal lumen					

### LED ARRAY

Lumen delivered up to 1670 lm / Lumen maintenance: L70 B10=50,000h

Driver	Optics	Version	LED	K	CRI	lm	SDCM	Finishes
0 On-Off	Y 7° Vey Narrow	F3D0 Trimless	HQ	3000	>90	1420	<3	12
T Phase-cut	P 12° Narrow		WW	3000	>80	1660	<3	28
V Dimm 1-10V	R 21° Medium		NN	4000	>80	1855	<3	31
D DALI	T 37° Wide		LED nominal lumen					

## 9 LED | Accessories

Accessoires pour optique/  
Accesorios de las ópticas

			<b>Description</b> Pare-lumière/ Visera antideslumbrante	<b>Code</b> 0.22100.00	<b>Finishes</b> 12 28 31
			<b>Description</b> Grille en nid d'abeilles/ Rejilla alveolar	<b>Code</b> 0.22120.00	<b>Finishes</b> 12 28 31
			<b>Description</b> Lentille Wall-Washer/ Lente wall-washer	<b>Code</b> 0.22140.00	<b>Finishes</b> 12 28 31
			<b>Description</b> Lentille pour faisceau elliptique/ Lente para haz de luz elíptico	<b>Code</b> 0.22180.00	<b>Finishes</b> 12 28 31

## 16 LED

Risk 0 1.40 IP20 850° CE CB EHC



Colerette apparente/  
Conaro visible

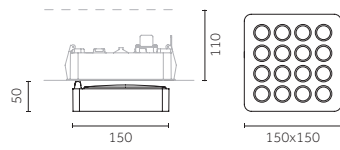

Colerette invisible/  
Conaro invisible

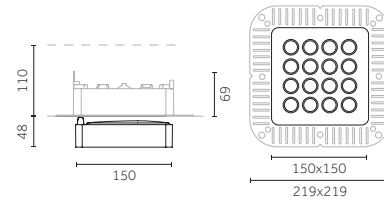

### 31 W LEDARRAY

Lumen delivered up to 3010 lm / Lumen maintenance: L70 B10=50,000h

Driver	Optics	Version	LED	K	CRI	lm	SDCM	Finishes
<b>0</b> On-Off	<b>Q</b> 7° Vey Narrow	<b>F3G0</b> Visible trim	<b>HQ</b>	3000	>90	2520	<3	<b>12</b>
<b>T</b> Phase-cut	<b>L</b> 12° Narrow		<b>WW</b>	3000	>80	3065	<3	<b>28</b>
<b>V</b> Dimm 1-10V	<b>M</b> 22° Medium		<b>NN</b>	4000	>80	3380	<3	<b>31</b>
<b>D</b> DALI	<b>N</b> 42° Wide		LED nominal lumen					

Code example:

**0 . Q F3G0 . HQ 12**

Accessories: p.615

Finishes: p.604

Photometric data:  
www.reggiani.net

#### Notes:

Version avec gradateur embarqué sur demande/ Modelo con dimmer en el aparato bajo pedido

### LEDARRAY

Lumen delivered up to 3010 lm / Lumen maintenance: L70 B10=50,000h

Driver	Optics	Version	LED	K	CRI	lm	SDCM	Finishes
<b>0</b> On-Off	<b>Y</b> 7° Vey Narrow	<b>F3G0</b> Trimless	<b>HQ</b>	3000	>90	2520	<3	<b>12</b>
<b>T</b> Phase-cut	<b>P</b> 12° Narrow		<b>WW</b>	3000	>80	3065	<3	<b>28</b>
<b>V</b> Dimm 1-10V	<b>R</b> 22° Medium		<b>NN</b>	4000	>80	3380	<3	<b>31</b>
<b>D</b> DALI	<b>T</b> 42° Wide		LED nominal lumen					

## 16 LED | Accessories

Accessoires pour optique/  
Accesorios de las ópticas

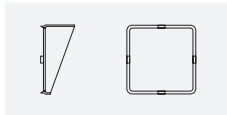
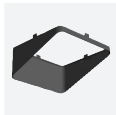

**Description**  
Pare-lumière/  
Visera antideslumbrante

**Code**  
**0.22110.00**

**Finishes**  
**12**  
**28**  
**31**

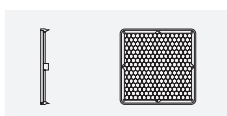

**Description**  
Grille en nid d'abeilles/  
Rejilla alveolar

**Code**  
**0.22130.00**

**Finishes**  
**12**  
**28**  
**31**

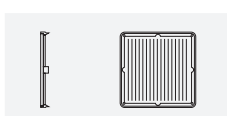

**Description**  
Lentille Wall-Washer/  
Lente wall-washer

**Code**  
**0.22150.00**

**Finishes**  
**12**  
**28**  
**31**



**Description**  
Lentille pour faisceau elliptique/  
Lente para haz de luz elíptico

**Code**  
**0.22190.00**

**Finishes**  
**12**  
**28**  
**31**

## Wall | 9 LED

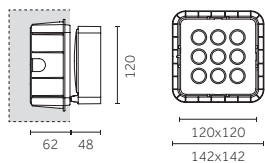

### 17 W LED ARRAY

Lumen delivered up to 1670 lm / Lumen maintenance: L70 B10=50,000h

Code example:

0 . K F3D0 . HQ 12

Accessories: p.616  
 Finishes: p.604  
 Photometric data:  
 www.reggiani.net

Notes:  
 Version avec gradateur embarqué sur demande/ Modelo con dimmer en el aparato bajo pedido

Driver	Optics	Version	LED	K	CRI	lm	SDCM	Finishes
<b>0</b> On-Off	<b>K</b> 7° Vey Narrow	<b>F3D0</b> Wall	<b>HQ</b>	3000	>90	1420	<3	<b>12</b>
<b>T</b> Phase-cut	<b>F</b> 12° Narrow		<b>WW</b>	3000	>80	1660	<3	<b>28</b>
<b>V</b> Dimm 1-10V	<b>G</b> 21° Medium		<b>NN</b>	4000	>80	1855	<3	<b>31</b>
<b>D</b> DALI	<b>H</b> 37° Wide							

LED nominal lumen

## Wall | 9 LED | Accessories

Accessoires pour optique/  
 Accesorios de las ópticas

		<b>Description</b> Pare-lumière/ Visera antideslumbrante	<b>Code</b> 0.22100.00	<b>Finishes</b> 12 28 31
		<b>Description</b> Grille en nid d'abeilles/ Rejilla alveolar	<b>Code</b> 0.22120.00	<b>Finishes</b> 12 28 31
		<b>Description</b> Lentille Wall-Washer/ Lente wall-washer	<b>Code</b> 0.22140.00	<b>Finishes</b> 12 28 31
		<b>Description</b> Lentille pour faisceau elliptique/ Lente para haz de luz elíptico	<b>Code</b> 0.22180.00	<b>Finishes</b> 12 28 31

## Wall | 16 LED

Risk 0 1.30 IP20 850° CE CB EHC

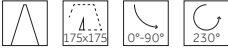
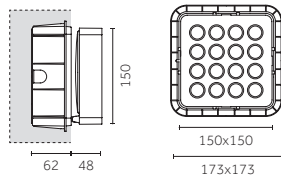

### 31 W LED ARRAY

Lumen delivered up to 3010 lm / Lumen maintenance: L70 B10=50,000h

Code example:

**0** . **K** **F3G0** . **HQ** **12**

Accessories: p.617

Finishes: p.604

Photometric data:  
www.reggiani.net

#### Notes:

Version avec gradateur embarqué sur demande/ Modelo con dimmer en el aparato bajo pedido

Driver	Optics	Version	LED	K	CRI	lm	SDCM	Finishes
<b>0</b> On-Off	<b>K</b> 7° Vey Narrow	<b>F3G0</b> Wall	<b>HQ</b>	3000	>90	2520	<3	<b>12</b>
<b>T</b> Phase-cut	<b>F</b> 12° Narrow		<b>WW</b>	3000	>80	3065	<3	<b>28</b>
<b>V</b> Dimm 1-10V	<b>G</b> 22° Medium		<b>NN</b>	4000	>80	3380	<3	<b>31</b>
<b>D</b> DALI	<b>H</b> 42° Wide		LED nominal lumen					

## Wall | 16 LED | Accessories

Accessoires pour optique/  
Accesorios de las ópticas

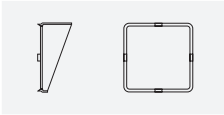
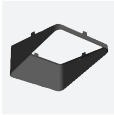

**Description**  
Pare-lumière/  
Visera antideslumbrante

**Code**  
**0.22110.00**

**Finishes**  
**12**  
**28**  
**31**

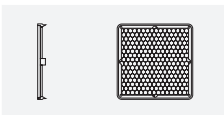

**Description**  
Grille en nid d'abeilles/  
Rejilla alveolar

**Code**  
**0.22130.00**

**Finishes**  
**12**  
**28**  
**31**

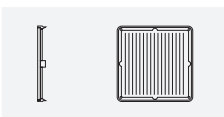

**Description**  
Lentille Wall-Washer/  
Lente wall-washer

**Code**  
**0.22150.00**

**Finishes**  
**12**  
**28**  
**31**

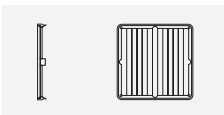

**Description**  
Lentille pour faisceau elliptique/  
Lente para haz de luz eliptico

**Code**  
**0.22190.00**

**Finishes**  
**12**  
**28**  
**31**



# — Splyt Track

## 9 LED

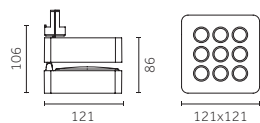
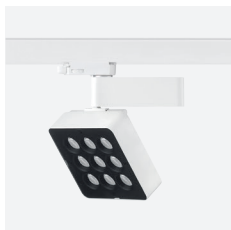

Code example:  
**0 . X F3D0 . HQ 12**

Accessories: p.620  
 Track/Binario: p.707  
 Finishes: p.604  
 Photometric data:  
 www.reggiani.net

Notes:  
 Version avec gradateur embarqué sur demande/ Modelo con dimmer en el aparato bajo pedido

### 17 W LEDARRAY

Lumen delivered up to 1670 lm / Lumen maintenance: L70 B10=50,000h

Driver	Optics	Version	LED	K	CRI	lm	SDCM	Finishes
<b>0</b> On-Off	<b>X</b> 7° Vey Narrow	<b>F3D0</b> Track	<b>HQ</b>	3000	>90	1420	<3	<b>12</b>
<b>T</b> Phase-cut	<b>B</b> 12° Narrow		<b>WW</b>	3000	>80	1660	<3	<b>28</b>
<b>V</b> Dimm 1-10V	<b>C</b> 21° Medium		<b>NN</b>	4000	>80	1855	<3	<b>31</b>
<b>D</b> DALI	<b>D</b> 37° Wide		LED nominal lumen					

## 9 LED | Accessories

Accessoires pour optique/  
 Accesorios de las ópticas

<b>Description</b> Pare-lumière/ Visera antideslumbrante	<b>Description</b> Grille en nid d'abeilles/ Rejilla alveolar	<b>Description</b> Lentille Wall-Washer/ Lente wall-washer	<b>Description</b> Lentille pour faisceau elliptique/ Lente para haz de luz elíptico
<b>Code</b> 0.22100.00	<b>Code</b> 0.22120.00	<b>Code</b> 0.22140.00	<b>Code</b> 0.22180.00
<b>Finishes</b> 12 28 31	<b>Finishes</b> 12 28 31	<b>Finishes</b> 12 28 31	<b>Finishes</b> 12 28 31

# 16 LED

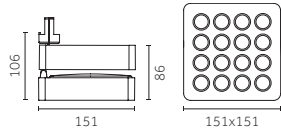

Code example:

**0 . X F3G0 . HQ 12**

Accessories: p.621  
Track/Binario: p.707  
Finishes: p.604  
Photometric data:  
www.reggiani.net

**Notes:**

Version avec gradateur embarqué sur demande/ Modelo con dimmer en el aparato bajo pedido

**31 W LED ARRAY**

Lumen delivered up to 3010 lm / Lumen maintenance: L70 B10=50,000h

Driver	Optics	Version	LED	K	CRI	lm	SDCM	Finishes
<b>0</b> On-Off	<b>X</b> 7° Vey Narrow	<b>F3G0</b> Track	<b>HQ</b>	3000	>90	2520	<3	<b>12</b>
<b>T</b> Phase-cut	<b>B</b> 12° Narrow		<b>WW</b>	3000	>80	3065	<3	<b>28</b>
<b>V</b> Dimm 1-10V	<b>C</b> 22° Medium		<b>NN</b>	4000	>80	3380	<3	<b>31</b>
<b>D</b> DALI	<b>D</b> 42° Wide		LED nominal lumen					

## 16 LED | Accessories

Accessoires pour optique/  
Accesorios de las ópticas

			<b>Description</b> Pare-lumière/ Visera antideslumbrante	<b>Code</b> <b>0.22110.00</b>	<b>Finishes</b> <b>12</b> <b>28</b> <b>31</b>
			<b>Description</b> Grille en nid d'abeilles/ Rejilla alveolar	<b>Code</b> <b>0.22130.00</b>	<b>Finishes</b> <b>12</b> <b>28</b> <b>31</b>
			<b>Description</b> Lentille Wall-Washer/ Lente wall-washer	<b>Code</b> <b>0.22150.00</b>	<b>Finishes</b> <b>12</b> <b>28</b> <b>31</b>
			<b>Description</b> Lentille pour faisceau elliptique/ Lente para haz de luz eliptico	<b>Code</b> <b>0.22190.00</b>	<b>Finishes</b> <b>12</b> <b>28</b> <b>31</b>





# — Splyt Surface

## 9 LED

Risk 0 0.85 IP20 Recycle 850° CE CB EAC

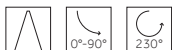
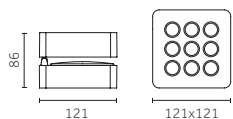

Code example:  
**0 . W F3D0 . HQ 12**

Accessories: p.624  
 Finishes: p.604  
 Photometric data:  
[www.reggiani.net](http://www.reggiani.net)

Notes:  
 Version avec gradateur embarqué sur demande / Modelo con dimmer en el aparato bajo pedido

17 W LED ARRAY		Lumen delivered up to 1670 lm / Lumen maintenance: L70 B10=50,000h						
Driver	Optics	Version	LED	K	CRI	lm	SDCM	Finishes
<b>0</b> On-Off	<b>W</b> 7° Vey Narrow	<b>F3D0</b> Surface	<b>HQ</b>	3000	>90	1420	<3	<b>12</b>
<b>T</b> Phase-cut	<b>U</b> 12° Narrow		<b>WW</b>	3000	>80	1660	<3	<b>28</b>
<b>V</b> Dimm 1-10V	<b>V</b> 21° Medium		<b>NN</b>	4000	>80	1855	<3	<b>31</b>
<b>D</b> DALI	<b>Z</b> 37° Wide		LED nominal lumen					

## 9 LED | Accessories

Accessoires pour optique/  
 Accesorios de las ópticas

	<b>Description</b> Pare-lumière/ Visera antideslumbrante	<b>Code</b> 0.22100.00	<b>Finishes</b> 12 28 31
	<b>Description</b> Grille en nid d'abeilles/ Rejilla alveolar	<b>Code</b> 0.22120.00	<b>Finishes</b> 12 28 31
	<b>Description</b> Lentille Wall-Washer/ Lente wall-washer	<b>Code</b> 0.22140.00	<b>Finishes</b> 12 28 31
	<b>Description</b> Lentille pour faisceau elliptique/ Lente para haz de luz elíptico	<b>Code</b> 0.22180.00	<b>Finishes</b> 12 28 31

# 16 LED

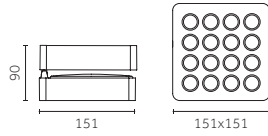

Code example:

**0** . **W** **F3G0** . **HQ** **12**

Accessories: p.625

Finishes: p.604

Photometric data:  
www.reggiani.net

**Notes:**

Version avec gradateur embarqué sur demande/ Modelo con dimmer en el aparato bajo pedido

**31 W LED ARRAY**

Lumen delivered up to 3010 lm / Lumen maintenance: L70 B10=50,000h

Driver	Optics	Version	LED	K	CRI	lm	SDCM	Finishes
<b>0</b> On-Off	<b>W</b> 7° Vey Narrow	<b>F3G0</b> Surface	<b>HQ</b>	3000	>90	2520	<3	<b>12</b>
<b>T</b> Phase-cut	<b>U</b> 12° Narrow		<b>WW</b>	3000	>80	3065	<3	<b>28</b>
<b>V</b> Dimm 1-10V	<b>V</b> 22° Medium		<b>NN</b>	4000	>80	3380	<3	<b>31</b>
<b>D</b> DALI	<b>Z</b> 42° Wide		LED nominal lumen					

## 16 LED | Accessories

Accessoires pour optique/  
Accesorios de las ópticas

		<b>Description</b> Pare-lumière/ Visera antideslumbrante	<b>Code</b> <b>0.22110.00</b>	<b>Finishes</b> <b>12</b> <b>28</b> <b>31</b>
		<b>Description</b> Grille en nid d'abeilles/ Rejilla alveolar	<b>Code</b> <b>0.22130.00</b>	<b>Finishes</b> <b>12</b> <b>28</b> <b>31</b>
		<b>Description</b> Lentille Wall-Washer/ Lente wall-washer	<b>Code</b> <b>0.22150.00</b>	<b>Finishes</b> <b>12</b> <b>28</b> <b>31</b>
		<b>Description</b> Lentille pour faisceau elliptique/ Lente para haz de luz eliptico	<b>Code</b> <b>0.22190.00</b>	<b>Finishes</b> <b>12</b> <b>28</b> <b>31</b>