

TRACK

Reggiani
REV 02 - Date 18 04 2017

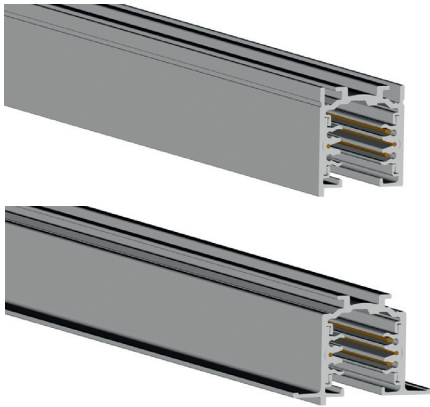

Mains voltage
(16 A at 230V)

3 circuits:

L1 + L2 + L3 + neutral + earth 16A/440V +
D+/D- 2x1A/50V
FELV AC (DALI)

DALI tracks are suitable for projectors
fitted with all driver versions: ON/OFF (0),
DIMM 1-10V (V), DALI (D.) and PHASE-CUT (T.)

Standard finishes:

- 10 White
- 21 Black
- 28 Metallised grey

Code example: **0.02030.00 10**

VERSIONS

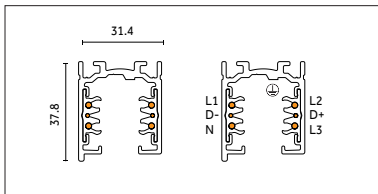

Surface-mounted track

- 0.02030.00** l. mm 1000
- 0.02031.00** l. mm 2000
- 0.02032.00** l. mm 3000
- 0.02033.00** l. mm 4000

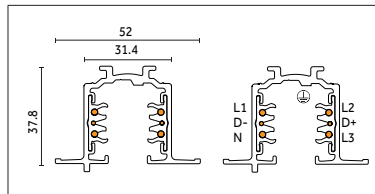

Recessed track

- 0.02034.00** l. mm 1000
- 0.02035.00** l. mm 2000
- 0.02036.00** l. mm 3000
- 0.02037.00** l. mm 4000

ELECTROMECHANICAL CONNECTIONS

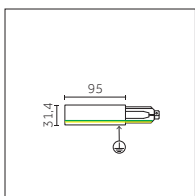

Live end feed

0.02038.00

Earth right

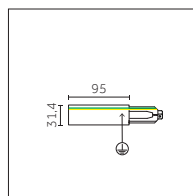

Live end feed

0.02039.00

Earth left

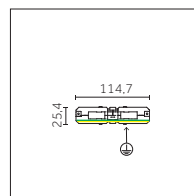

Straight connector

0.02040.00

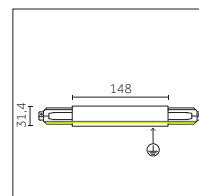

Live middle feed

0.02042.00

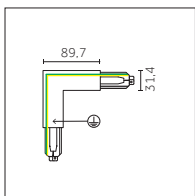

L-connector

0.02043.00

Earth outside

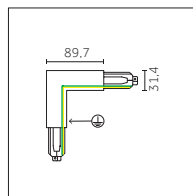

L-connector

0.02044.00

Earth inside

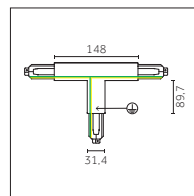

T-connector

0.02045.00

Earth inside / left

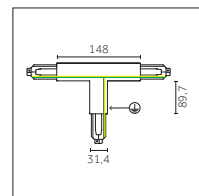

T-connector

0.02046.00

Earth inside / right

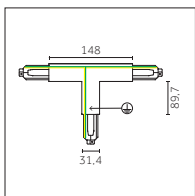

T-connector

0.02047.00

Earth outside / left

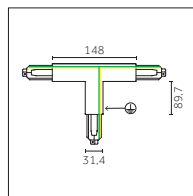

T-connector

0.02048.00

Earth outside / right

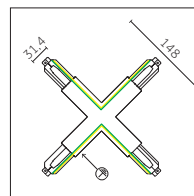

X-connector

0.02049.00

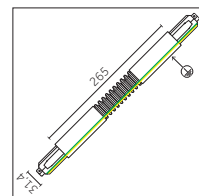

Flexible connector

0.02050.00

Luminaire constructed in conformity with standards EN 60598-1 and EN 60570, and with Directives 2006/95/EC (LV), 2004/108/EC (EMC), 2009/125/EC (Ecodesign), 2002/96/EC (WEEE) and 2011/65/EC (RoHS).

ACCESSORIES FOR ELECTROMECHANICAL CONNECTIONS (RECESSED TRACK)

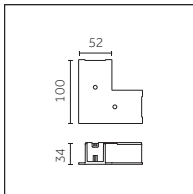

L-connector cover
0.02056.00

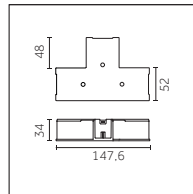

T-connector cover
0.02057.00

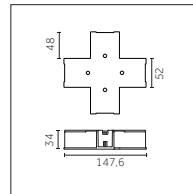

X-connector cover
0.02058.00

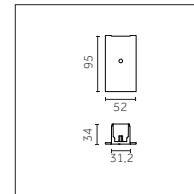

Live end feed cover
L 95 mm
0.02059.00

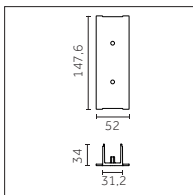

Live middle feed cover
L. 147,6 mm
0.02060.00

ACCESSORIES (SURFACE-MOUNTED TRACK)

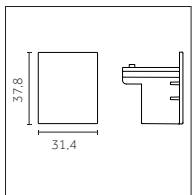

End cap (dead end) for surface-mounted track with locking screw
0.02041.00

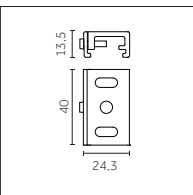

Ceiling bracket
0.02054.00

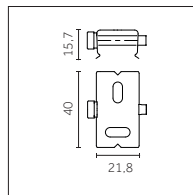

Ceiling clamp
0.02065.00



Cable cutter
0.02064.0000

ADATTATORE

6-conductor asymmetric adapter (3 circuits+N+control system) with circuit selector

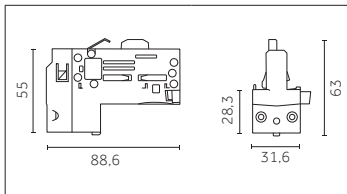

Technical data / Specifications:
- frequency: 50Hz
- nominal current and voltage: 6/10A-250V
- polycarbonate body
- copper alloy contacts
- max. capacity: 100 N
0.02066.0000

ADAPTER ACCESSORIES

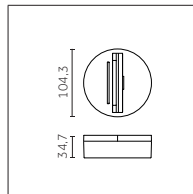

Monopoint for ceiling mounting of DALI adapter without using the track
0.02062.00

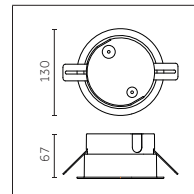

Adapter for recessed mounting of DALI monopoint (reference 0.02062.00)
0.02063.00

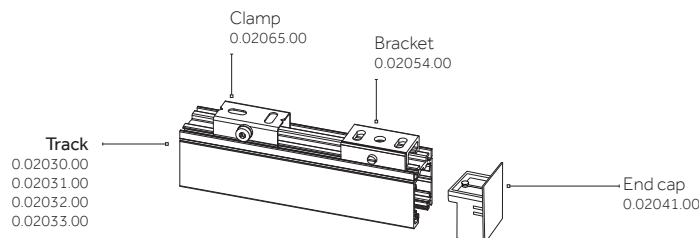

PENDANT MOUNTING (SURFACE-MOUNTED TRACK)

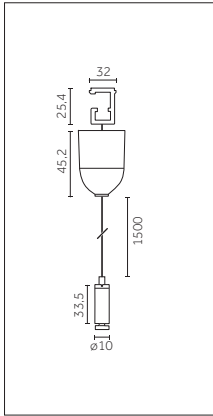

- Suspension set composed of:
- ceiling bracket
 - wire clamp
 - plastic ceiling rose (Ø 32 mm)
 - steel wire (Ø 1.5 mm; L=1500 mm) with M6 terminal

0.02052.00

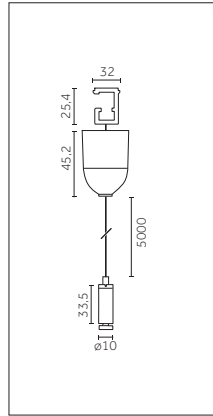

- Suspension set composed of:
- ceiling bracket
 - wire clamp
 - plastic ceiling rose (Ø 32 mm)
 - steel wire (Ø 1.5 mm; L=5000 mm) with M6 terminal

0.02053.00

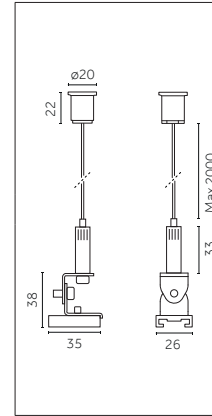

- Suspension kit with 2-m long wire and counter-balance system

0.25864.00

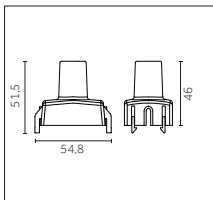

- Track set composed of:
- point clamp suspension M6
 - plastic cover

0.02051.00

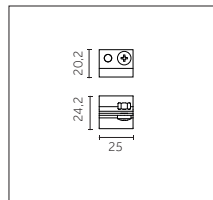

- Short T-bracket for suspension

0.02055.00

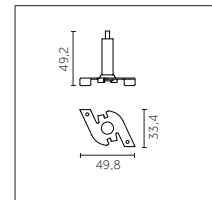

- Clamp with gripper for rapid track installation

0.02061.00

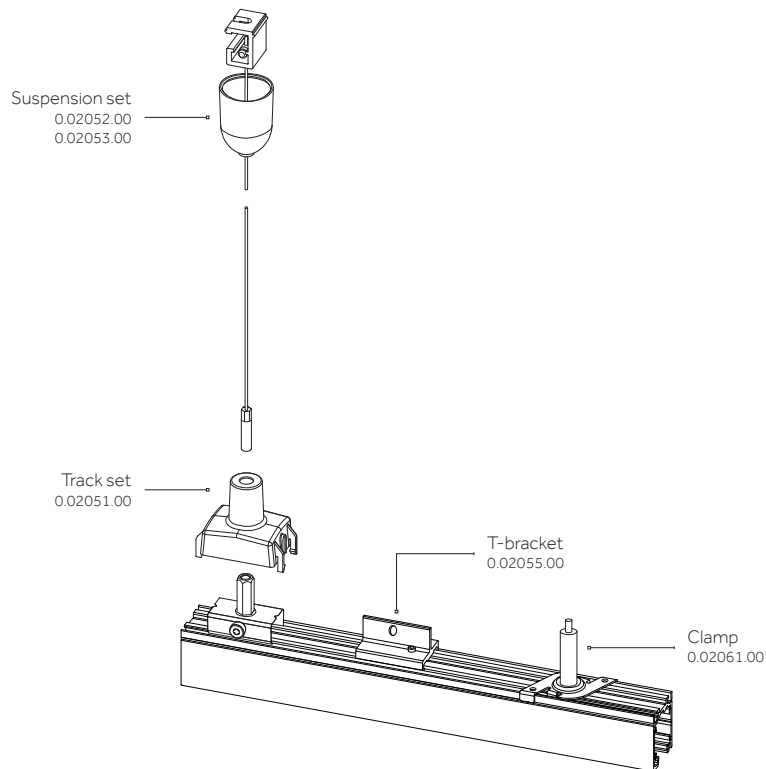

Luminaire constructed in conformity with standards EN 60598-1 and EN 60570, and with Directives 2006/95/EC (LV), 2004/108/EC (EMC), 2009/125/EC (Ecodesign), 2002/96/EC (WEEE) and 2011/65/EC (RoHS).

BREAKDOWN DIAGRAM

Reggiani
REV 02 - Date 18 04 2017

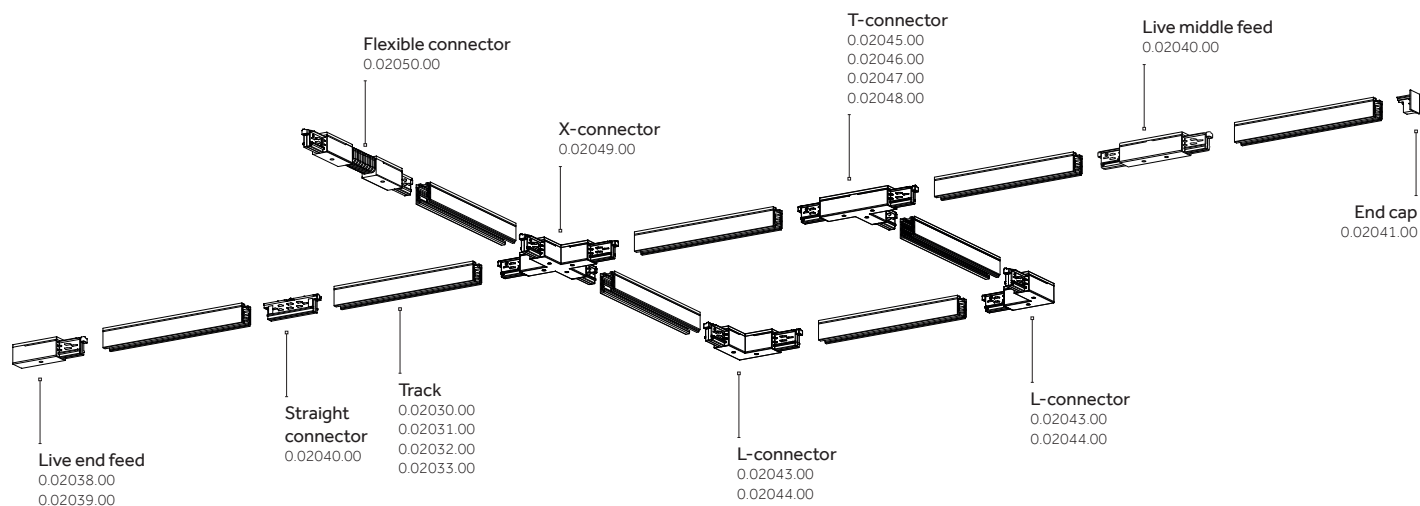

Use specialised technicians only to install systems and replace parts. Disconnect system from power supply and ensure compliance of installation procedure with national standards. The user and/or installer are responsible for ensuring electrical, mechanical and thermal compatibility of the system with the structures where they will be anchored and with regard to the luminaires connected to them.

WARNING:

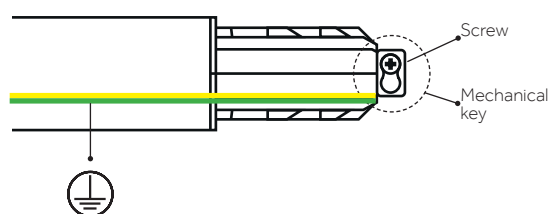

MECHANICAL KEYS

A mechanical key on the track profile assures correct connection of the track lengths. Live end feeds and connectors also have a mechanical key (with screw - see diagram). This must be taken into account to select the right component. In the catalogue drawings of these accessories, the yellow-green line indicates the earthing contact.

Luminaire constructed in conformity with standards EN 60598-1 and EN 60570, and with Directives 2006/95/EC (LV), 2004/108/EC (EMC), 2009/125/EC (Ecodesign), 2002/96/EC (WEEE) and 2011/65/EC (RoHS).